

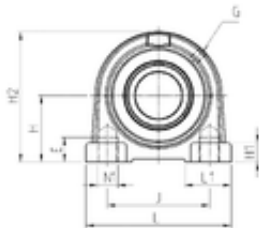

SKF BEARING LTD.

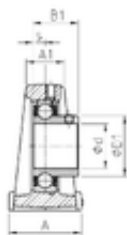

SNR USPAE212 bearing units

Bearing No. USPAE212

| | |
|-------------------------------|---------|
| Bore Diameter | 60 mm |
| d | 60 mm |
| s | 14,9 mm |
| A | 60 mm |
| A1 | 42 mm |
| B1 | 53,7 mm |
| D1 | 74,9 mm |
| E | 20 mm |
| H | 69,9 mm |
| H1 | 16 mm |
| H2 | 140 mm |
| J | 118 mm |
| L | 150 mm |
| L1 | 32 mm |
| Thread (G) | R1/8" |
| Thread (N1) | M16 |
| Weight | 3,8 Kg |
| Basic dynamic load rating (C) | 52,5 kN |

USPAE212 Bearing 2D drawings and 3D CAD models